

# Southco® Push to Close Latches

## Flush Pull

- Single, round-hole installation
- Keylocking style restricts access
- Corrosion-resistant materials
- Inside actuation when locked or unlocked
- Pull to open

### Medium Size

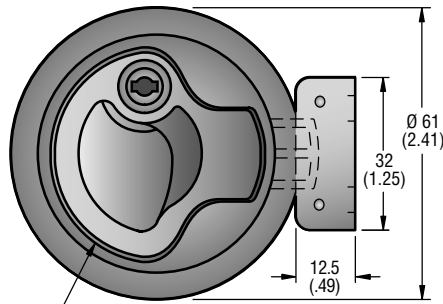

LOCKING HANDLE shown.  
Also available as NON-LOCKING,  
see below.

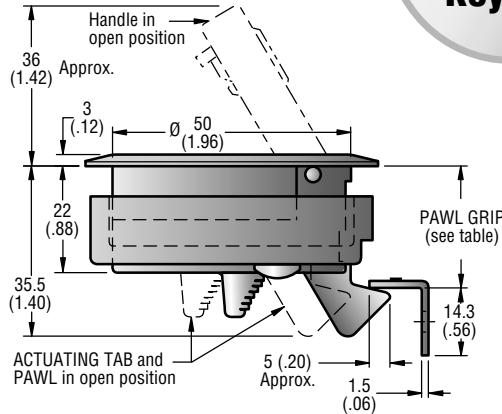

†  
**Available  
3 Wafer  
Keylock**

**NEW  
LARGER  
Version**

### Large Size

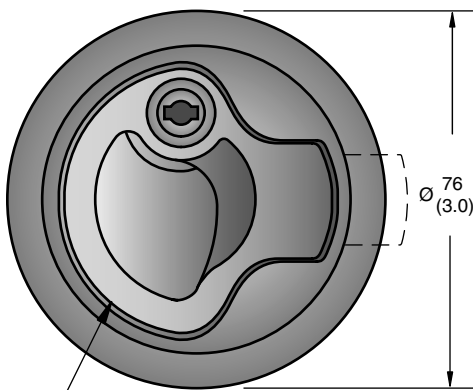

LOCKING HANDLE shown.  
Also available as NON-LOCKING,  
see below.

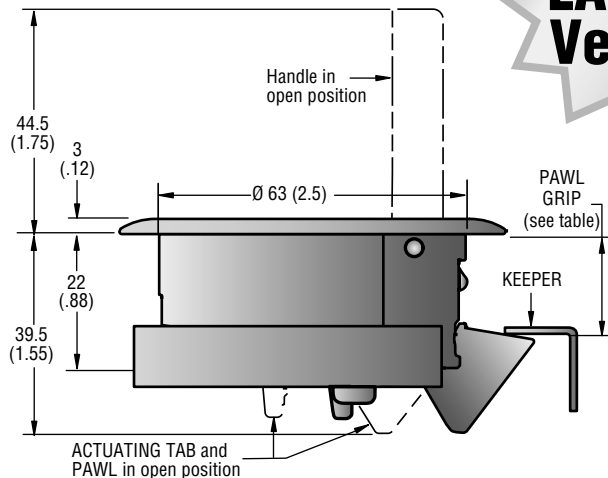

PART NUMBER								PANEL THICKNESS A		MOUNTING BRACKET HEIGHT E	MOUNTING SCREW LENGTH	PAWL GRIP ±0.5 (±.02)	ØB	C ±1.5 (±.06)	D ±1 (±.04)
Non-locking				Locking**				MIN.	MAX.						
Stainless Steel	Black	White	Beige	Stainless Steel	Black	White	Beige								
Medium Size															
M1-61-8 •	M1-61 •	M1-61-1 •	M1-61-7 •	M1-41-8 • †	M1-41 •	M1-41-1 •	M1-41-7 •	2 (.075)*	7 (.275)	14 (.55)	16 (.63)	25.5 (1.00)	50 <sup>+1.2 -0</sup> 2.0 ( <sup>+0.15 -0.031</sup> )	41 (1.62)	33 (1.30)
M1-62-8 •	M1-62 •	M1-62-1 •	M1-62-7 •	M1-42-8 • †	M1-42 •	M1-42-1 •	M1-42-7 •	7 (.275)	12 (.475)	14 (.55)	20 (.81)				
M1-63-8 •	M1-63 •	M1-63-1 •	M1-63-7 •	M1-43-8 • †	M1-43 •	M1-43-1 •	M1-43-7 •	12 (.475)	17 (.675)	3.8 (.15)	16 (.63)				
M1-64-8 •	M1-64 •	M1-64-1 •	M1-64-7 •	M1-44-8 • †	M1-44 •	M1-44-1 •	M1-44-7 •	17 (.675)	22 (.875)	3.8 (.15)	20 (.81)				
Large Size															
M1-25-61-18 •	-	-	-	M1-25-41-18 •	-	-	-	2 (.075)*	12 (.475)	22 (.875)	-	20 (.75)	63.5 ±0.5 (2.5 ±.02)	52.5 (2.07)	27 (1.1)
M1-25-61-28 •	-	-	-	M1-25-41-28 •	-	-	-	2 (.075)*	12 (.475)	22 (.875)	-	32 (1.25)			39 (1.54)
M1-25-62-18 •	-	-	-	M1-25-42-18 •	-	-	-	12 (.475)	22 (.875)	12 (.475)	-	20 (.75)			27 (1.1)
M1-25-62-28 •	-	-	-	M1-25-42-28 •	-	-	-	12 (.475)	22 (.875)	12 (.475)	-	32 (1.25)			39 (1.54)

\*M1-X1, M1-X1-1, M1-X1-7 and M1-X1-8 can be mounted in a MIN. panel thickness of 1 (.040) but require shorter mounting screws, not supplied.

\*\*Two keys supplied per latch.

† For 3 wafer keylock in Medium Size Stainless Steel Version only, substitute a 7 for the 4 in the part number, M1-71-8, M1-72-8, M1-73-8 or M1-74-8.

## Installation

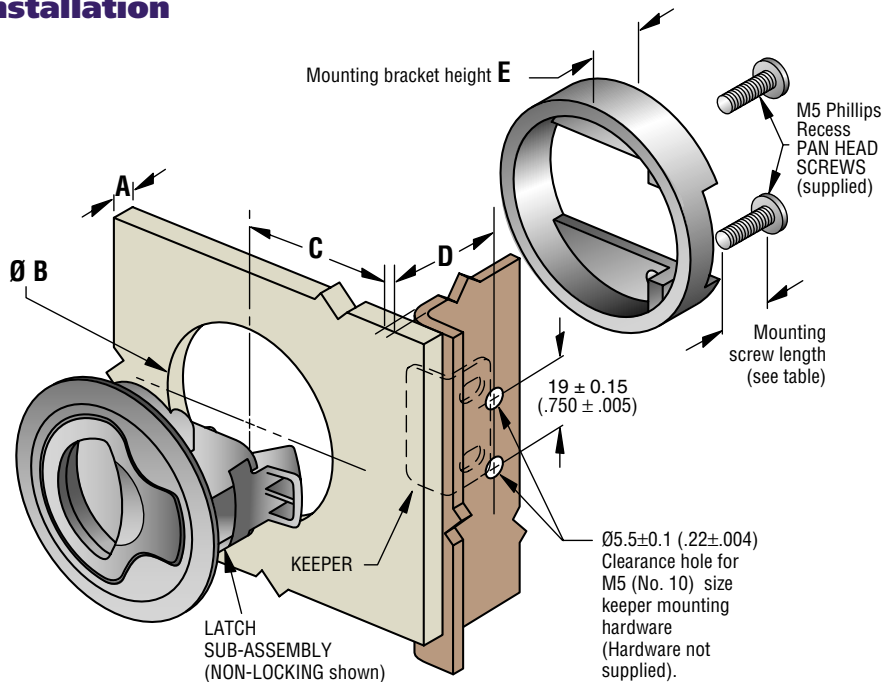

## Product Strength Guidelines

### Medium Size

Maximum recommended static load exerted by keeper on pawl:

PC/PBT Blend: 270 N (60 lbs.)

Stainless Steel: 835 N (187 lbs.)

Maximum tightening torque on mounting screws:  
1.7 Nm (15 in.-lbs.)

Operating Temperature Range: -18 °C (0 °F) to  
60 °C (140 °F)

Flammability Rating: UL94-HB (PC/PBT Blend)

### Large Size

Maximum recommended static load exerted by  
keeper on pawl:

Stainless Steel: 1165 N (262 lbs.)

Maximum tightening torque on mounting screws:  
1.7 Nm (15 in.-lbs.)



## Material and Finish

### Plastic Version

HOUSING, HANDLE AND MOUNTING BRACKET: PC/PBT blend, black, white or beige.

LOCK: Mineral filled nylon, black.

PAWL: Acetal, black, white or beige.

PIN: 302 Stainless steel, passivated plus black oxide.

KEYS, SPRING, KEEPER AND SCREWS:  
300 Series stainless steel, passivated.

### Stainless Steel Version

HOUSING, HANDLE, PAWL, LOCK PLUG and MOUNTING BRACKETS: CF-8M stainless steel (nominal cast equivalent of 316 SS), electropolished.

LOCK PLUG O-RING: Buna-N, natural.

LOCK PLUG RETAINING RING:

420 Stainless steel.

PIN: 302 Stainless steel, passivated.

KEYS, SPRINGS, KEEPER AND SCREWS:  
300 Series stainless steel, passivated.

## Operation

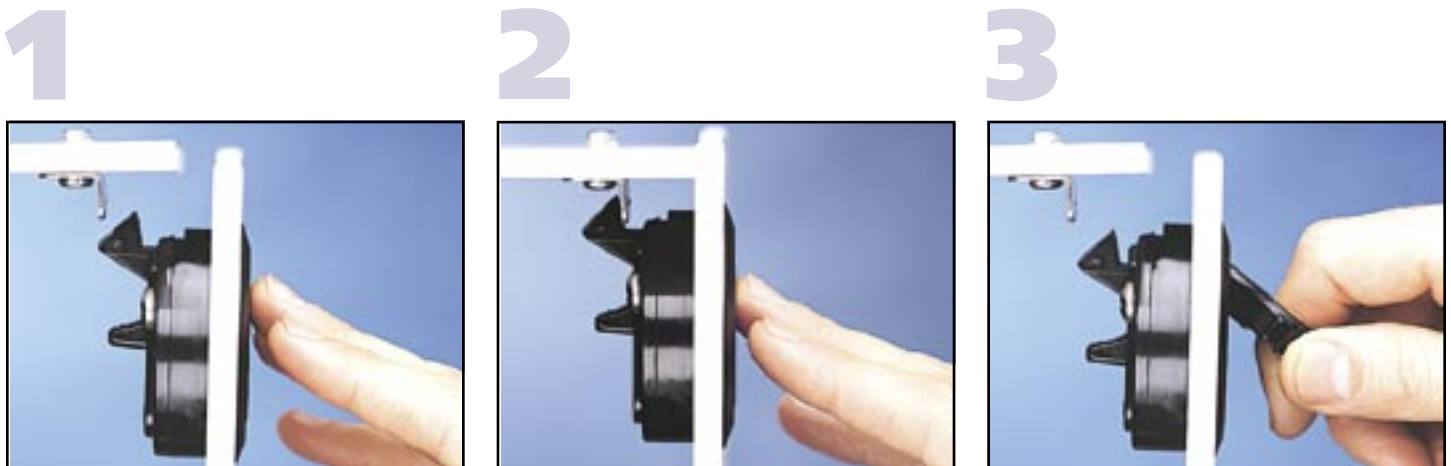

To close, a firm push on the panel...

latches the door.

To open, simply pull the flush handle  
or slide inside activation tab.

millimeter (inch)  
millimeter  
(inch)

Dimensions without tolerances are for reference only.

# Southco® Push to Close Latches

## Flush Simplicity

- Pull to open
- Very low profile
- Corrosion-resistant materials
- Single, round-hole installation

Push to Close Latches  
Visible

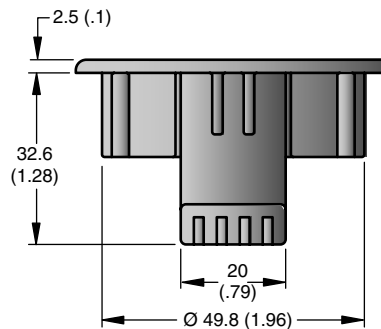
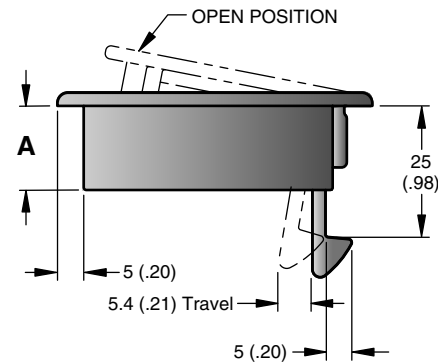
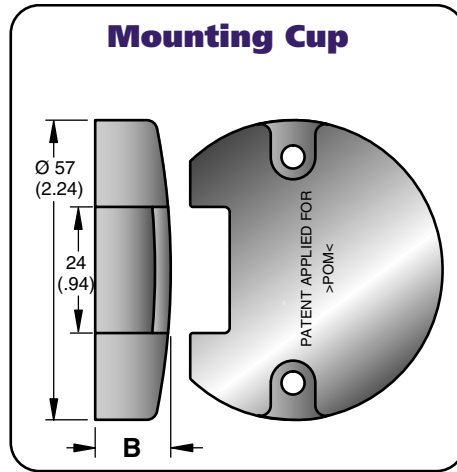
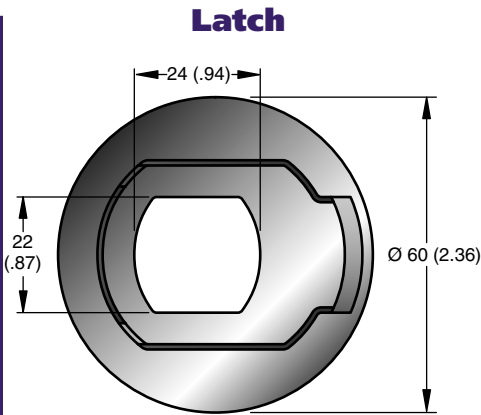

## Panel Preparation

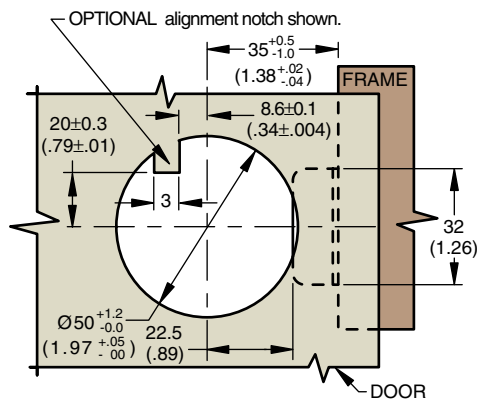

Align latch with frame, secure with mounting cup and self tapping screws (supplied with all parts).

**CAUTION:** Do not over-tighten screws.

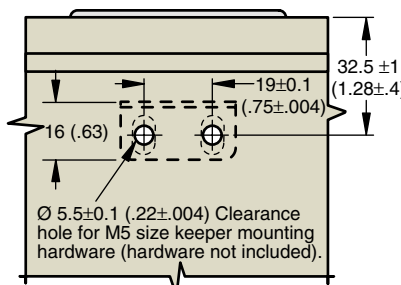
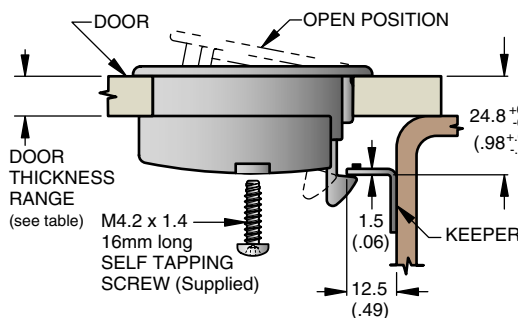

Lift the handle to open...



Push the door to latch.

DOOR THICKNESS RANGE	A	B	PART NUMBER
1 (.04) - 7 (.28)	16 (.63)	20.4 (.80)	M1-81 •
7 (.28) - 13 (.51)	16 (.63)	14.3 (.57)	M1-82 •
13 (.51) - 19 (.75)	22 (.87)	14.3 (.57)	M1-83 •

## Material and Finish

LATCH and MOUNTING CUP: Acetal, black.  
KEEPER: 304 Stainless steel, passivated.  
SCREWS: 302 Stainless steel, passivated.

Minimum Pawl Engagement: 3.0 (.12)

## Product Strength Guidelines

(To assist in your product selection; samples are available for your evaluation.)

Maximum static load: 135 N (30 lbs.)

Average ultimate load: 175 N (39 lbs.)

Maximum tightening torque on mounting screws: 0.5 to 0.8 N•m (4.4 to 7.1 in.-lbs.)

**Flammability Rating:** UL94-HB

**Operating Temperature Range:**

-40°C (-40°F) to 80 °C (176°F)

millimeter (inch)  
millimeter  
(inch)

Dimensions without tolerances are for reference only.

# M1 Push to Close

## Small · Stainless steel



- Single, round-hole installation
- Keylocking style restricts access
- Premium finish and corrosion resistance

### Material and Finish

Latch: 316 grade stainless steel and bright polished  
 Spacer: Nylon black  
 Contact Southco for other finishes

### Performance Details

Max. static load: 545N (122 lbs)

### Accessories

One Tubular key supplied per latch  
 For additional keys order  
 M7-88-9121324-S



Spacer: M1-510-96-1  
 (Sold separately)



### Installation Notes

Use the reference table to determine if a spacer is required for the door thickness, and the correct mounting bracket orientation. The spacer shown is in the forward position.

### Part Number Selection

For full specification, ordering details and downloadable CAD/3D models go to....



[www.southco.com](http://www.southco.com)  
[info@southco.com](mailto:info@southco.com)

©Southco NA M1 3-08

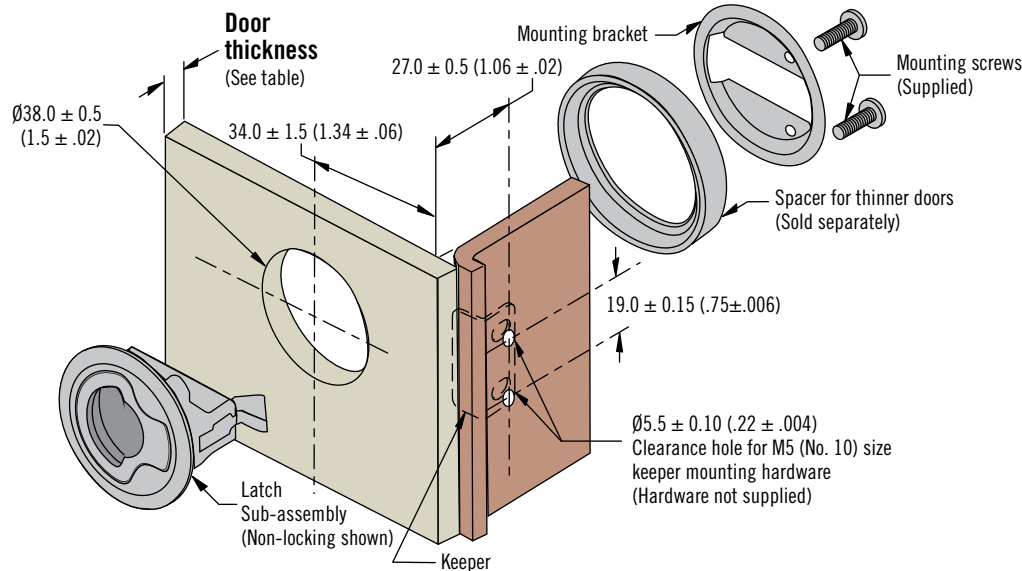
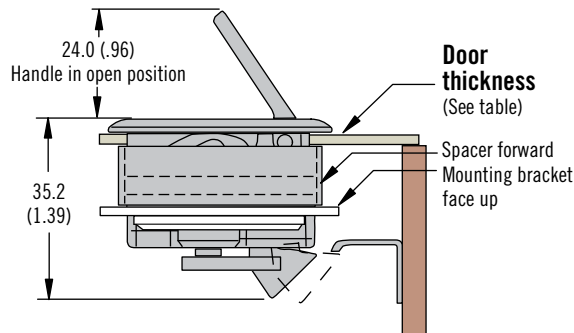
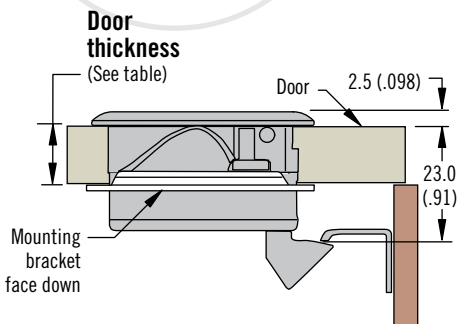
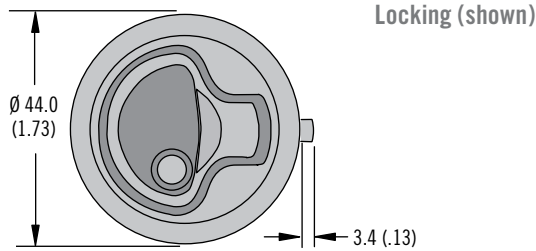
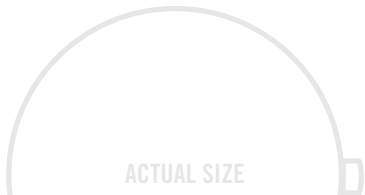

Door Thickness	Spacer Orientation	Mounting Bracket Orientation
1.0 (.04) to 5.0 (.20)	Forward	Face Up
5.0 (.20) to 9.0 (.36)	Reverse	Face Up
9.0 (.36) to 14.5 (.57)	(not required)	Face Up
14.5 (.57) to 21.0 (.83)	(not required)	Face Down

**southco**  
 CONNECT · CREATE · INNOVATE

M1 - 15 - L 1 - 8

- L Lock style**
- 4 Locking (one tubular key supplied)
  - 6 Non locking